

SUOCCO S500



 **SUOKONE**

MERITRACTOR

FOREST - CONSTRUCTION - AGRICULTURE

Power and performance for land clearing



Pictured with
dual rubber tracks.

SUOCO S500

Equipped with mechanical power take-off, the Suocco S500 is the most efficient crawler tractor on the market. The Suocco S500 is able to operate under conditions where conventional tractors lose power and traction. Thanks to adequate engine power and a mechanical power take off, the S500 enable quicker, more efficient operations, at a lower cost per hectare.

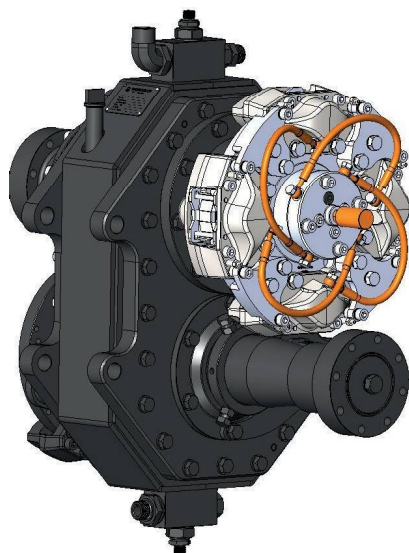

← Suokone-made PTO gearbox is specially designed for transmitting high torques safely. The integrated POC clutch works as an overload/release clutch. The APTOR system switches PTO to neutral if the defined sliding % is exceeded.

Modular structure → enables the use of different track systems:

- steel tracks
- single rubber tracks
- dual rubber tracks

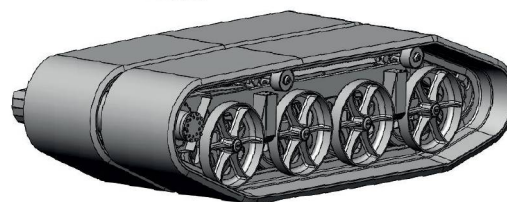
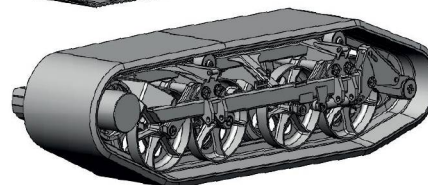
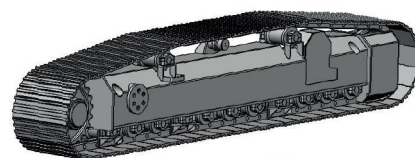

SPECIFICATIONS

ENGINE

| | |
|--------|--|
| Model | VOLVO TAD 1643 VE |
| | 6 cylinders, volume 984CU.In (16.12 ltr) |
| Power | 768 hp (565 kW) |
| Torque | 3263 Nm (1500 rpm) |

DRIVE TRANSMISSION

| | |
|--|----------------------|
| 2-speed with stepless variation. 2 piston pumps. | |
| Tractive power | 570 hp (420 kW) |
| Tractive force | 40000 lbs (180kN) |
| Travel speed, area 1 | 0-6 mph (0-10 km/h) |
| Travel speed, area 2 | 0-12 mph (0-20 km/h) |

TRACKS

| | |
|----------------------|---------------------------------------|
| Modular structure | detachable |
| Single rubber tracks | width: 31,5 In. (800mm) |
| Twin rubber tracks | width: 2 x 31,5 In. (800mm) |
| Steel tracks | width: 24-28-31,5 In. (600-700-800mm) |

CONNECTION OF EQUIPMENT

| | |
|------------------|----------------------|
| 3-point linkage | KAT III - IV |
| Lifting capacity | 19980 lbs. (9000 kg) |
| PTO speed | 1000 rpm |
| PTO capacity | 816 hp (600 kW) |

SERVICEABILITY

| | |
|--------------------|---------------------|
| Hydraulic oil tank | 69 gal. (260 ltr.) |
| Fuel Tank | 160 gal. (600 ltr.) |
| Cooling capacity | 16 gal. (60 ltr.) |

ELECTRIC VOLTAGE

| | |
|-----------|------------|
| Voltage | 24 V |
| Batteries | 2 x 225 Ah |

DIMENSIONS

| | Single tracks | Twin rubber tracks |
|-----------------|----------------------|----------------------|
| Height | 146 In. (3700mm) | 146 In. (3700mm) |
| Length | 193 In. (4900mm) | 193 In. (4900mm) |
| Width | 122 In. (3100mm) | 181 In. (4600mm) |
| Weight | 35520 lbs. (16000kg) | 45510 lbs. (20500kg) |
| Ground pressure | 3.7 Psi (260g/cm²) | 2.4 Psi (170g/cm²) |

We reserve the right to change specifications or modify the design without notice.



www.suokone.com

SUOKONE OY
88610 Vuokatti, Finland

Tel. +358 8 66 62 011
suokone@suokone.com